

HOUSE LOCATION SURVEY vs. SUBDIVISION PLAT

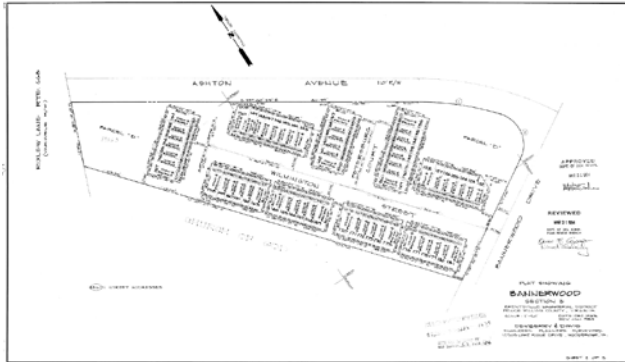

A House Location Survey:

- Shows boundary of parcel / land
- Shows where house is on land
- Shows distance from property edges to house
- Can figure length of house



A Subdivision Plat:

- Shows every lot in the subdivision
- Does not show buildings or its dimensions

**County Offices and County Courthouse only keep
SUBDIVISION PLATS on file. They do not keep
HOUSE LOCATION SURVEYS.**

If you need a HOUSE LOCATION SURVEY try one of the following resources:

- Your settlement Lender
- The Surveyor used for settlement
- Check your settlement papers
- Lawyer involved in the settlement